

B-29 SUPER UPDATE KIT

for use with the 1:48 scale Monogram B-29 Superfortress kit

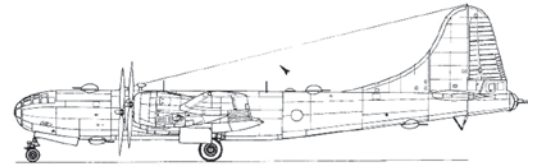

Made in USA

www.FlightlineEngineering.com • info@flightlineengineering.com

To facilitate easiest installation possible, please read and understand all directions before assembly.

1. With a sharp nipper tool, carefully remove all parts from their supports (these supports are necessary for the 3D printing process). A fine tooth precision saw can also be used where supports are situated closely to one another. Work SLOWLY and CAREFULLY. Always wear eye protection, as small support clippings may fly off. 3D printed resin parts can be glued with cyanoacrylate glue or epoxy glue.

2. All parts should be primed prior to painting. Acrylic primer is recommended. Other primers can be used, but test first for compatibility.

3. If any print resolution lines are present on parts with large, smooth surfaces (such as cowls, etc.), part may be lightly wet sanded with 600 grit wet-or-dry sandpaper.

SPECIAL NOTES:

Some procedures shown here require advanced modeling skills, in particular the installation of the lower nacelle replacement parts (purchased separately). Please note that the use of these lower nacelle replacement parts requires major modifications to the wings, and slight modifications made to the Monogram kit part no. 44 (left and right Wheel Plates).

- PARTS LIST -



COWL (X4)



COWL SCOOP (X4)



COWL FLAPS (X4)



ENGINE FRONT (X4)



ENGINE REAR (X4)



IGNITION HARNESS (X4)



EXHAUST MANIFOLDS (X4)



PROP BLADES (X4)



PROP SPINNER (X4)



PROP ASSEMBLY JIG



MAIN TIRE (X4)



MAIN WHEEL OUTER (X4)



MAIN WHEEL INNER (X4)

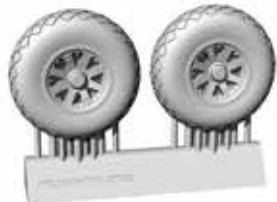

NOSE WHEELS



PROP SHAFT (X4)



www.FlightlineEngineering.com • info@flightlineengineering.com

© Copyright 2024 Flightline Engineering. Reproduction without permission prohibited.

COWL ASSEMBLY

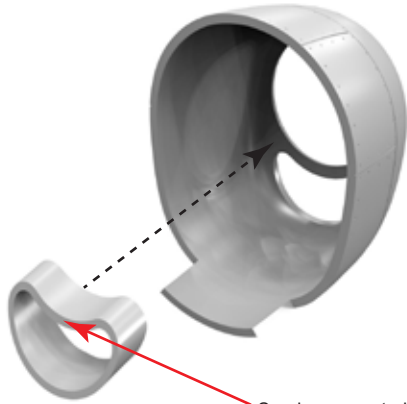

Sand away material along this edge if cowl scoop interferes with engine.

PROPELLER ASSEMBLY



SIDE VIEW

ENGINE ASSEMBLY

1. Trim the metal prop shaft to a length of .60". File off any resulting rough edges.

2. Insert metal prop shaft through nosecone. Center peg on crankcase is designed to hold prop shaft in place. Test-fit engine front and rear, gradually sanding down center peg to where only a slight drag is felt when shaft is spun. Once proper tension is achieved, glue engine halves together. **CAUTION! Take care to not get any glue on the prop shaft!** The engine halves are keyed to each other.

3. Add pushrods using .020 styrene rod or wire, if desired.

4. Add ignition ring, then exhaust manifolds.

